

**PENNSYLVANIA STREET**  
SCALE: HORIZ. 1"=40' VERT. 1"=4'

- NOTES:**
1. Manhole frames & covers to be constructed by Sewer Contractor & below official grade shown, and upon completion of paving, the paving contractor shall set manhole frames and covers to said official grade.
  2. All laterals shall be 6" I.C.R. and extended 5' beyond property line.
  3. Exact location of sewer laterals to be determined in the field.
  4. Sewer laterals to be constructed of either "Wedge-Lock," "Speed Seal," "Ceramic Wedge," "Bond Seal" clay pipe or asbestos cement pipe. Sewer mains shall be constructed of either "Wedge-Lock," "Speed Seal," or "Bond Seal" clay pipe.
  5. Manhole steps shall not be required. Manhole frames & covers shall be Althamer Foundry No. A-1180, "Silent Night" or approved equal.
  6. Construct 2 1/2" "Plant-Mix" pavement in all streets as shown.
  7. All work executed on these plans shall be done in conformity with applicable provisions of Specifications No. 2271.
  8. BENCH MARK: Barrow in corner of N.E. corner Atlantic & Virginia S.W. 1181.87
  9. A network shall be obtained from the San Bernardino County Flood Control District before commencing work on storm drain manholes.

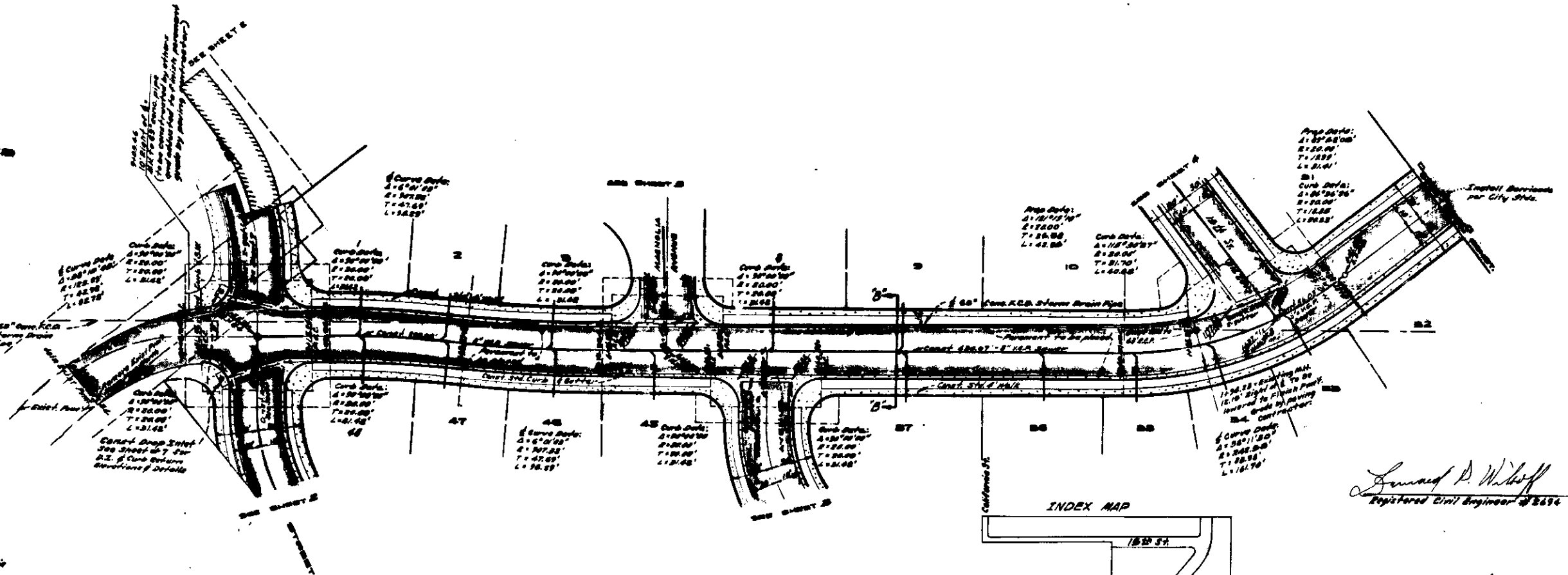

**PLAN PENNSYLVANIA STREET**  
SCALE: 1"=40'

*Edward P. Wilhoff*  
Registered Civil Engineer No. 2694

**IMPROVEMENT PLANS & PROFILES**  
**TRACT 6425**

APPROVED BY THE BOARD OF SUPERVISORS  
April 2, 1928  
10.786